

20L Natural Stackable UN Approved Jerry Can

DESCRIPTION

This high density polyethylene (HDPE) drum is suitable for storage, handling and transportation of chemical products or foodstuffs. Standard colour is natural.

PRODUCT

Nominal/Brimful Capacity (litres): 20,0 / 22,3 ±2.0%
 Nominal Tare Weight (g): 830g ±5.0%
 Minimum Internal Test Pressure (kpa): 200
 Body Material: High Molecular Weight HD Polyethylene
 PCR Content: 0%
 Fabrication: Extrusion blow moulded
 Embossings: UN approval, Date, Recycling symbol, Manufacturers sign.
 Ink-jet marking bottom right centre panel: "AST UK - Date/Month/Year Hour:Minute:Second"



APPROVALS

UN marking: 3H1/Y1.9/200*/B/AST-130047

BODY DIMENSIONS

Height: 383 mm ± 5.0 mm
 H Stacking Height: 376 mm ± 5.0 mm
 Label Panel L x H: 220 mm x 215 mm ± 5.0 mm
 B x L Cross Section: 250 x 290 mm ± 5.0 mm

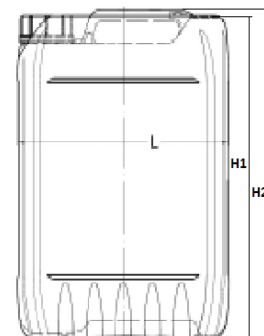
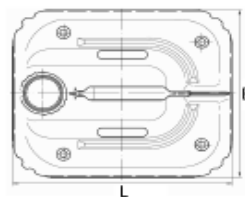

NECK TYPE

Neck Thread Formation: External, with tamper evident ratchet
 Position: Centre of cap 40mm from edge of drum on mould part line
 Height (h1): 22,4 mm ±1.0 mm
 External diameter (d1): 59,0 mm ±1,5 mm
 Internal diameter (d2): 54,0 mm ±1,5 mm
 Internal neck diameter (d3): 48,5 mm ±1,5 mm
 Pitch of Thread: 6

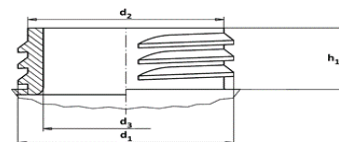

CLOSURE SYSTEM

Type: Screw cap DIN 61 (Vent and Non Vent), made from HDPE
 Closing Torque: 23-25 Nm at ambient temperature
 Closure sealing type: EPE foam gasket

SHIPPING

	Packaging
Bale/Pallet dimensions:	1200 x 1000
Drums quantity on one layer	16
Layers of drums on one pallet/bale	4/3
Drums quantity on one pallet/bale:	64/48
Pallets quantity in one full truck:	26
Palletisation height:	2.8m
Polymer Weight Per Pallet:	92.96kg
Packaging tape UN colour:	Purple
Quantity in one full truck load:	2,912

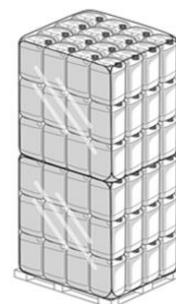

DECLARATION OF COMPLIANCE

- 1.) Generally ■ EU-Framework Regulation on material and articles intended for food contact: (EC) No 1935/2004
- 2.) Raw Materials / Composition ■ Regulation (EU) No 10/2011 and amendments
- EU-regulations: ■ FDA 21 CFR 177.1520
- Non-EU-regulations

ADDITIONAL DETAILS

It is the fillers responsibility to check chemical and physical compatibility between the container and product filled.

